



[Find Awareness: eXplore Your Nature]

FAXYN, OPC

OZEMCare Customer Care & After-Sales Support Center
Units I & K, Rizalina Building II, 1675 Quezon Avenue,
West Triangle, 1104 Quezon City, Philippines

FOR CUSTOMER ASSISTANCE/INQUIRIES:



(+63) 2 825 68777



(+63) 917 656 8777



ozemcare@ozemtech.net



ozemcares



ozemcares



ozemtech.net

MADE IN KOREA

USER MANUAL

NEWTON

SERIES 3205e

Model
WH0323-3205e

OZEMTECH™

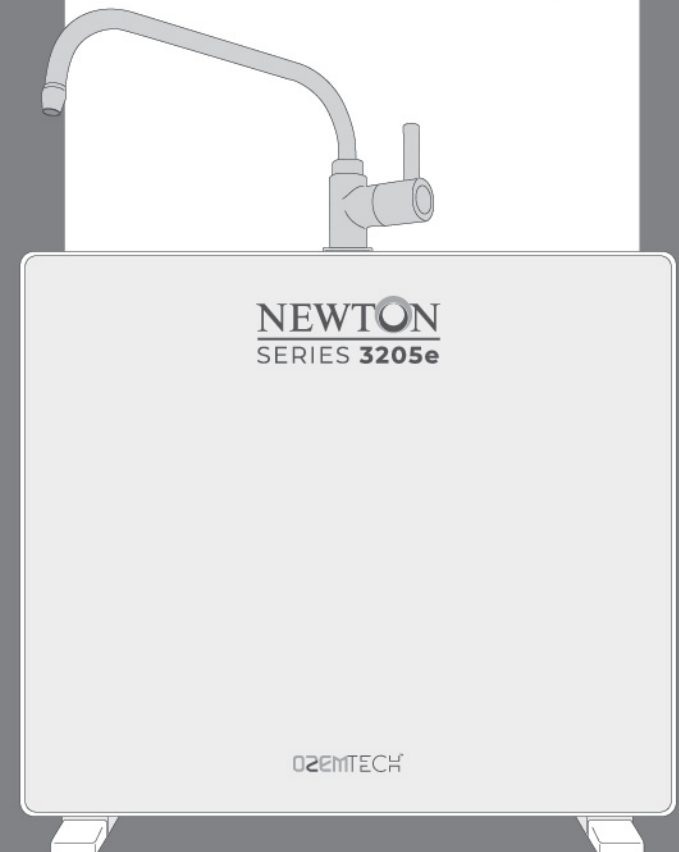

Please read this manual for your safety and proper use. Keep this manual carefully.
It has the product warranty.

FOR YOUR SAFETY

Precautions 03

FOR INFORMATION

Parts of NEWTON Series 3205e 06

Filtration System 07

Features 08

Filter Replacement Guide 09

How to Use and Cleaning 11

Troubleshooting 12

Installation 12

Specifications 14

Product Warranty 15

Serial No.

PRODUCT WARRANTY

NEWTON Series 3205e | Model No. WH0323-3205e

Date Manufactured	<input type="text"/>
Date Purchased	<input type="text"/>
Date Installed	<input type="text"/>
Customer's Name	<input type="text"/>
Address	<input type="text"/>
	<input type="text"/>
Mobile/Telephone No.	<input type="text"/>
Email	<input type="text"/>

WARRANTY GUIDE

- 1 - The warranty period is 12 months from the date of purchase. The warranty covers repair or replacement of parts, and service free of charge. The replacement of unit is only for cases proven to be a factory defect.
- 2 - During the warranty period the following cases are exempted from coverage of warranty:
 - a - Malfunction caused by reckless or improper use.
 - b - Malfunction caused by natural disaster or fortuitous event.

Product Name	NEWTON Series 3205e	
Model Number	WH0323-3205e	
Power Supply	None	
External Dimensions	14in (35.6cm) Width X 4.4in (11.2cm) Depth X 12.8in (32.5cm) Height	
Product Weight	3.2kgs.	
Recommended Water Consumption	10L / a day (4 people based)	
Service Condition	Working pressure	147-294kPa
	Working temperature	5~35°C
	Usable feed water	Tap water



CAUTION

Please read the following precautions carefully to avoid damage.

If not observed, slight injury or damage to property could occur.



This symbol notifies the dangers caused by improper use. Please read carefully and follow the precautions.

Precautions for Installation



Do not bend or twist the inlet hose.
❖ Failure to do so can cause malfunction.

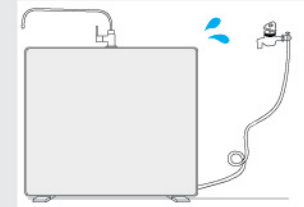

Do not install this unit under direct sunlight and avoid high heat areas.
❖ Failure to do so can cause deformation of the product exterior.

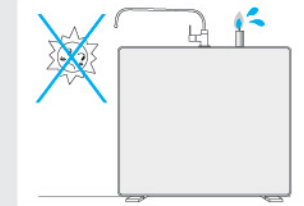

Do not place the unit on a bumpy or uneven surface floor.
❖ Failure to do so can cause malfunction.

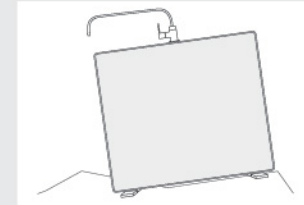

Do not connect to hot water supply.
❖ Failure to do so can cause damage to filters and/or result in poor performance.





Do not apply unnecessary force when using the unit.
❖ Failure to do so can cause malfunction and damage.

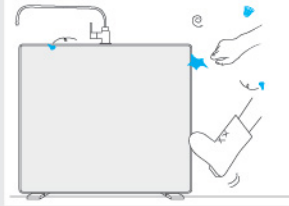

Do not attempt to repair, disassemble or modify the unit. It may void any product warranty unless done by an authorized technician following XYN User Manual.

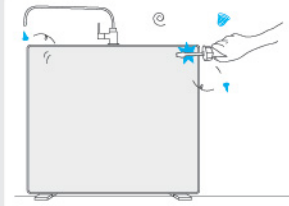

Precautions for Use



Do not place heavy objects on top of the unit.
❖ Failure to do so can cause damage to the unit.

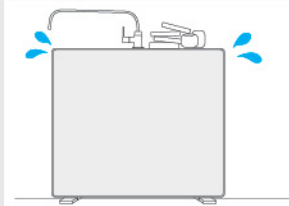

Do not move the unit while it is in operation, and connected to water.
❖ Failure to do so can cause malfunction.

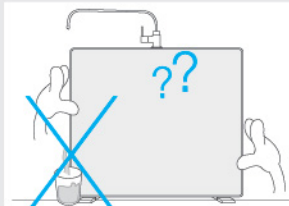

Do not use Benzene or gasoline when cleaning the unit.
❖ Failure to do so can cause discoloring, peeling and/or damage to the exterior of the unit.

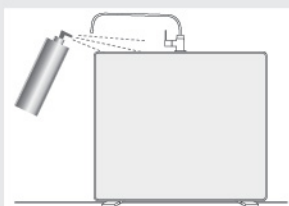

3

Open the front cover by pressing the rectangular holes on each side and pull the cover away.

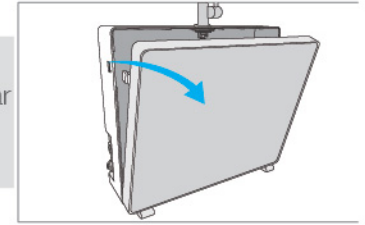

4

Check each connection for water leakage.
❖ Always check for water leakage.

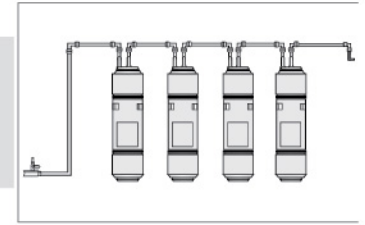

5

Close the filter chamber cover.

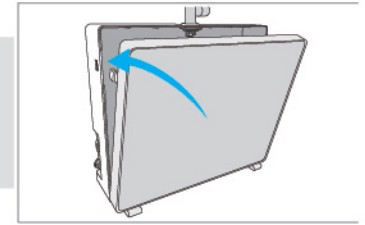

6

Connect the hose to the Water Inlet located in the left side of the unit.

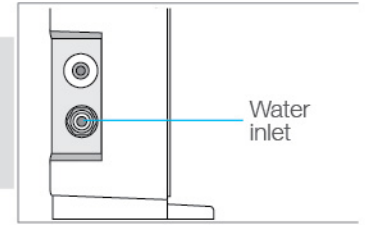

7

Open the main Water Supply Gate Valve or Faucet Diverter.

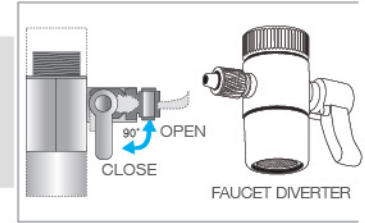

TROUBLESHOOTING

❖ Please refer to the common troubleshooting solutions before contacting **OZEMCare Customer Care & After-Sales Support Center (CCASSC)**.

Problem	Possible Solutions
Unpleasant water taste	Replace the filters.
No water comes out	Check if the Water Supply Valve is locked or if the filter the replacement period is overdue.
Decreased water production	If low-pressure water is supplied to the unit, less amount of filtered water is produced.
Water leakage	Please contact OZEMCare CCASSC after you lock the Water Supply Valve.

- ❖ Please contact the **OZEMCare CCASSC** for the filter replacement and solutions for the problem that you might have.
- ❖ We can not take responsibility for any damage caused by replacing filters by a third party who is not our serviceman.

INSTALLATION

1 Place the unit on an even and hard surface or counter in an upright position.

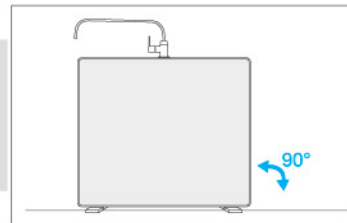

2 Close the main Water Supply Gate Valve or Faucet Diverter.

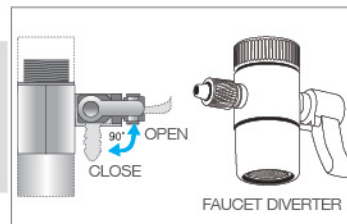

PRECAUTIONS



Please adhere to local community guidelines when discarding parts or filters and/or disposing of the unit entirely.
❖ Failure to do so can cause environmental pollution.



When installing the unit, always use genuine parts.
❖ Failure to do so can cause water leakage or damage to the water dispenser.



When replacing filters, always use genuine filters.
❖ Failure to do so can cause poor performance and poor water quality.

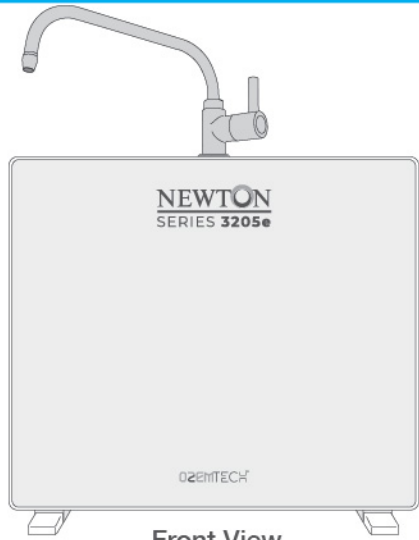

Front View

Faucet Sediment Filter Pre Carbon Filter UF Membrane Filter Post Block Filter Water Inlet

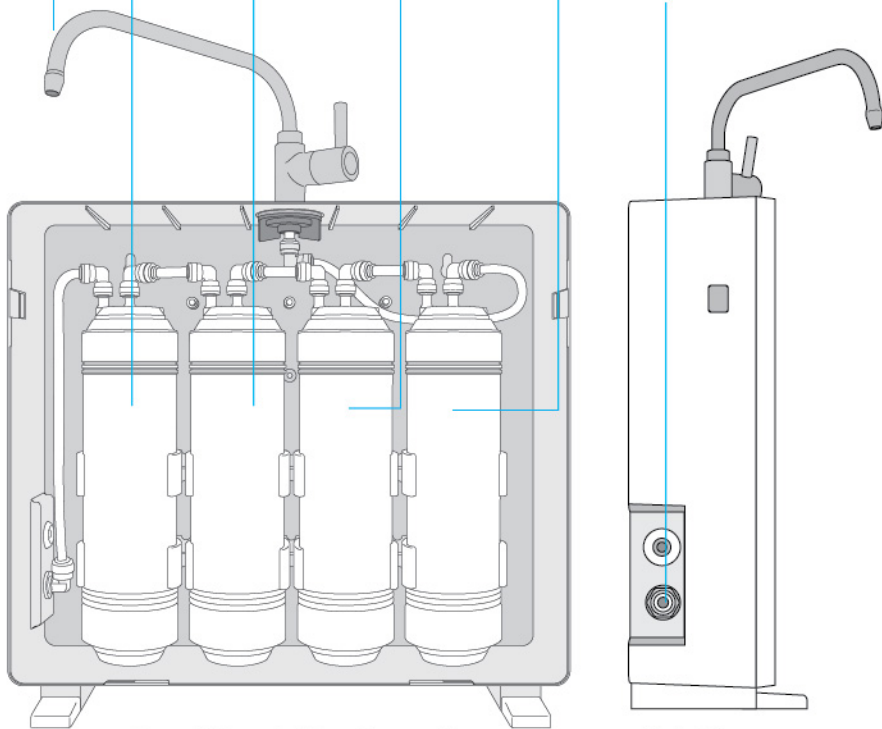

Front View (without cover)

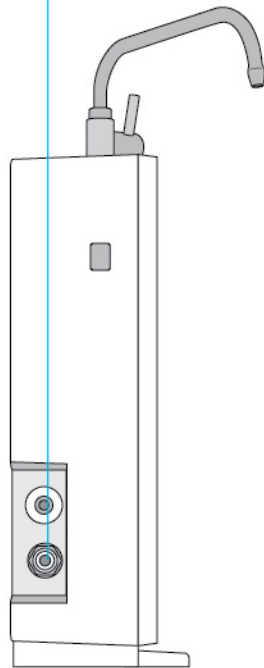

Side View

How to Use

- ❖ Turn the faucet lever clockwise to dispense water and counter-clockwise to stop.

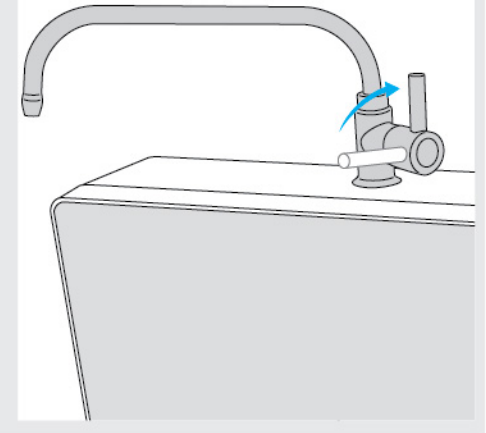

Cleaning

- 1 - Clean the outer part of the unit.
 - ❖ Internal cleaning is not required as the water dispenser does not include a water tank.

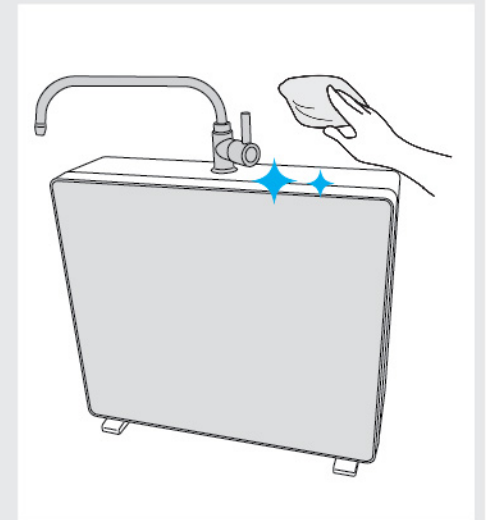

4

Flushing of the newly-installed replacement filter.

- ❖ Flush the new filters to remove the carbon dust for 10 minutes or until the carbon dust is no longer visible.

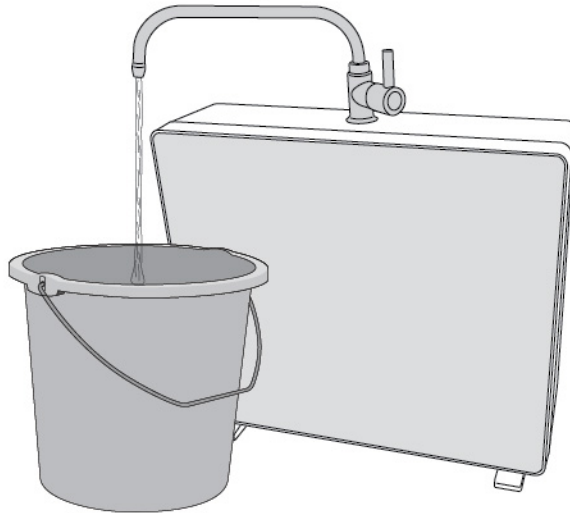

- According to the filter replacement cycle, replace filters regularly.
- If the filter is not regularly changed, it could degrade the water quality.
- The filter replacement cycle may vary depending on feed water quality and consumption.
- When replacing the filter, use our genuine one. (If not, we can not guarantee filter efficiency and water quality.)

❖ *Note: We can not take responsibility for any damage caused by replacing filters by a third party who is not our serviceman.*



- When replacing filters, ask the serviceman to do the flushing procedure to new filters for more than 10 minutes. (If not, it could degrade water quality)
- Even if your water consumption is not much, it is recommended to follow regular filter replacement cycle.
- Above filter replacement cycles are based on normal feedwater condition and 1500 liters of filtered water efficiency. (The cycle does not mean a quality guarantee period.)
- The recommended exchange schedule is based on 10 liters in a day consumption for house use. (4 people-based)

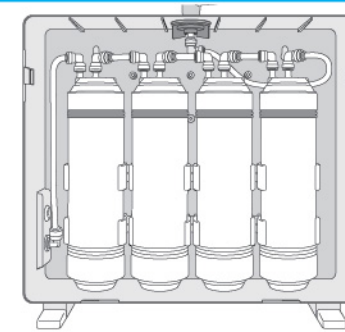

WATER FILTRATION PROCESS

	1 STEP	2 STEP	3 STEP	4 STEP
Filter Name	Sediment Filter	Pre-Carbon Filter	UF Membrane Filter	Post Block Filter
Expected Replacement	Estimated 6 months	Estimated 6 months	Estimated 12 months	Estimated 12 months

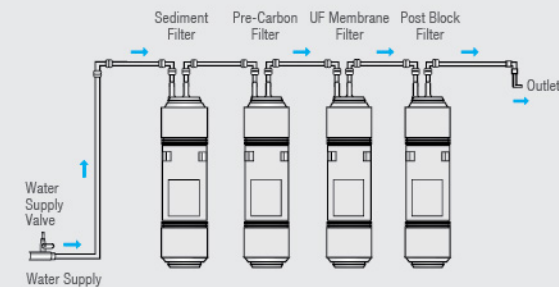

- ❖ Consumable parts (such as fitting, tubing, float valve, etc.) are required to be replaced approximately every 2 years. Failure to replace these parts can cause property damage by water leakage.
- ❖ When using or replacing new filters, all filters must be flushed properly. Please contact **OZEMCare CCASSC** for proper filter flushing guidelines.



Initial Setup

1. Open the Water Supply Valve.
2. Write the date of the usage on the filter as the basis for the next replacement.
3. Be sure to flush new filters before use. Let the water flow from the dispensing nozzle until the water is clear and free from carbon dust.
 - ❖ *Close the Water Supply Valve when not utilized for a long time.*

FEATURES

> Can be operated without electricity

- ❖ It operates without using power, so there are no running costs.

> Slim size 11.5cm (4.5in)

- ❖ The unit fits anywhere, especially in a small kitchen area.

> Four (4) filters for quality filtration

Sediment Filter

- ❖ Removes sediment particles such as bits of rust, dirt, and sand more than 5 microns in size.

Pre Carbon Filter

- ❖ Absorbs harmful chemicals such as chlorine, fluoride, bad taste, and odor. Makes the water tastes refined.

UF Membrane Filter

- ❖ Removes minute contaminants and pathogens with 0.1 - 0.4 micron size.

Pre Carbon Filter

- ❖ Polishes the water. Further absorbs harmful chemicals, bad taste, and an odor that could still be present in the water. Makes the water taste even more refined.

> Easy replacement filters

- ❖ The filters are easy to replace with flathead screwdriver or wrench for fittings to use..

> Airless direct water filtration system (Point-of-use System)

- ❖ It prevents secondary contamination of water.

FILTER REPLACEMENT GUIDE

1

Close the main Water Gate Valve.



A - Open the filter chamber.

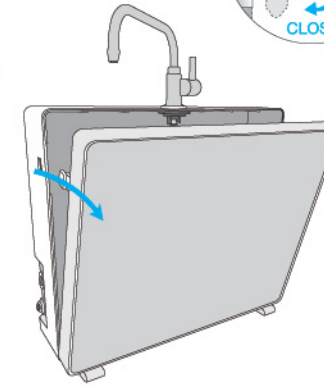

2

Drain the remaining water by opening the Faucet Lever.

A - Remove the pressure and remaining water in the filter and pipe by extracting ambient water.

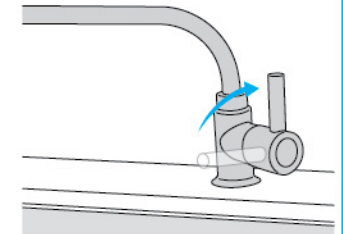

3

Replace filters.

A - Take out the old filter and remove the Quick Connect Fittings on top of the filter.

- ❖ Filter replacement cycle: 6 months and 12 months
- B - Insert the Quick Connect Fittings into the new filter and place it back into the filter chamber.



Disassemble

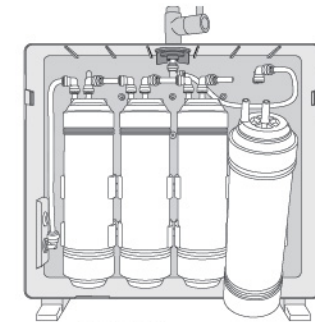

Connect